

PARTS BREAKDOWN

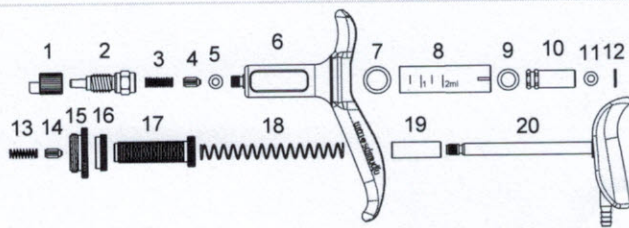

- | | |
|----------------------------------|------------------------------------|
| 1. Needle Nut (SN45/N) | 11. Push Rod Seal Ring (SP338) |
| 2. Needle Mount (SN373/N) | 12. Piston Collar (SN309) |
| 3. Delivery Valve Spring (BP235) | 13. Inlet Valve Spring (BP235) |
| 4. Delivery Valve (WX1513) | 14. Inlet Valve (WX1513) |
| 5. Needle Mount Seal Ring (SP66) | 15. Back Cap (SP1397) |
| 6. Body (SXXN358) | 16. Dose Adjustor Lock Nut (SN261) |
| 7. Cylinder Seal Ring (SP220) | 17. Dose Adjustor (SN260) |
| 8. Cylinder (SH621) | 18. Return Spring (SP514) |
| 9. Piston Seal Ring (SP1245) | 19. Spring Cover (SN265) |
| 10. Piston (SN370) | 20. Push Rod (SXXN598) |

MODEL	DOSE RANGE	INCREMENTS	CODE
2ml	0.1ml – 2ml	0.1ml	PAS686
Also available in:			
1ml	0.1ml – 1ml	0.1ml	PAS564
5ml	0.5ml – 5ml	0.5ml	PAS1198

PAS686 (2ml)

KIT NO.	PART NAME	PART NO.
WX750	Major Service Kit	3,4,5,7,8,9,11,13,14,18.
WX1062	Minor Service Kit	3,4,5,7,9,11,13,14,18.

PLEASE ORDER BY KIT AND PART NAME

PAS564 (1ml)

KIT NO.	PART NAME	PART NO.
WX749	Major Service Kit	Not Illustrated.
WX1118	Minor Service Kit	Not Illustrated.

PLEASE ORDER BY KIT AND PART NAME

PAS1198 (5ml)

KIT NO.	PART NAME	PART NO.
WX111	Major Service Kit	Not Illustrated.
WX1061	Minor Service Kit	Not Illustrated.
WX610	Vitamin ADE Kit	Not Illustrated.

PLEASE ORDER BY KIT AND PART NAME